

GRID A

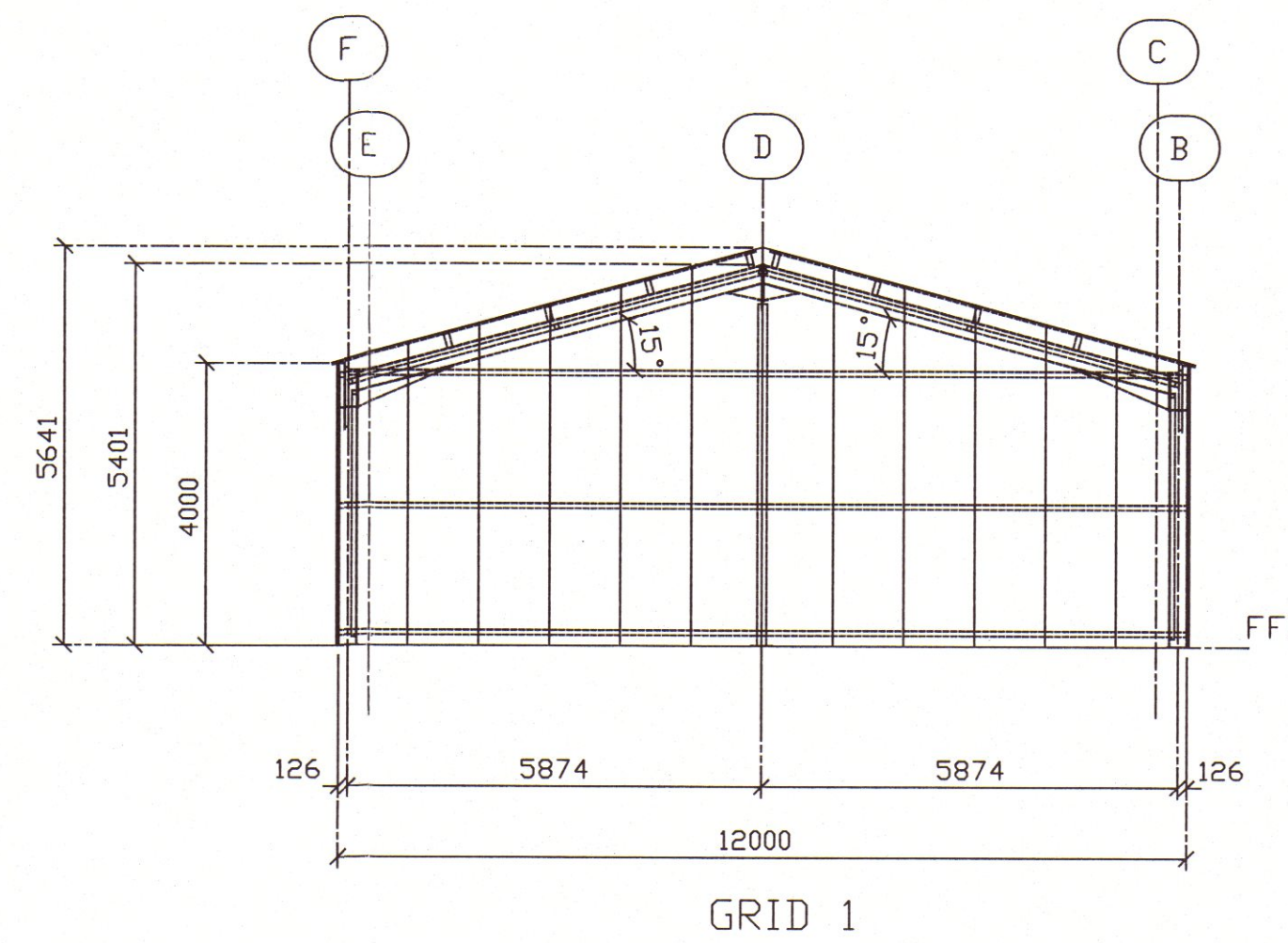

GRID 1

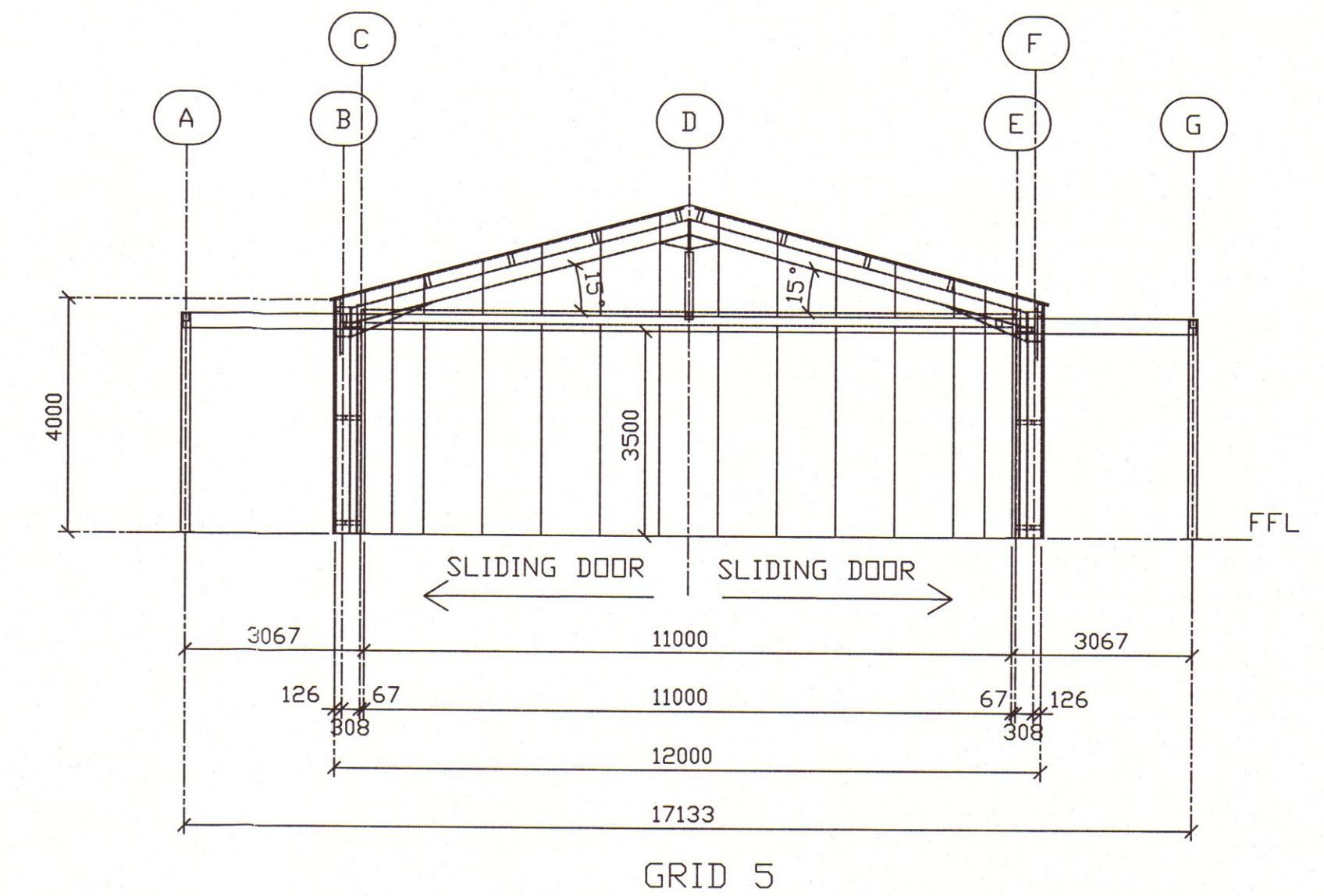

GRID 5

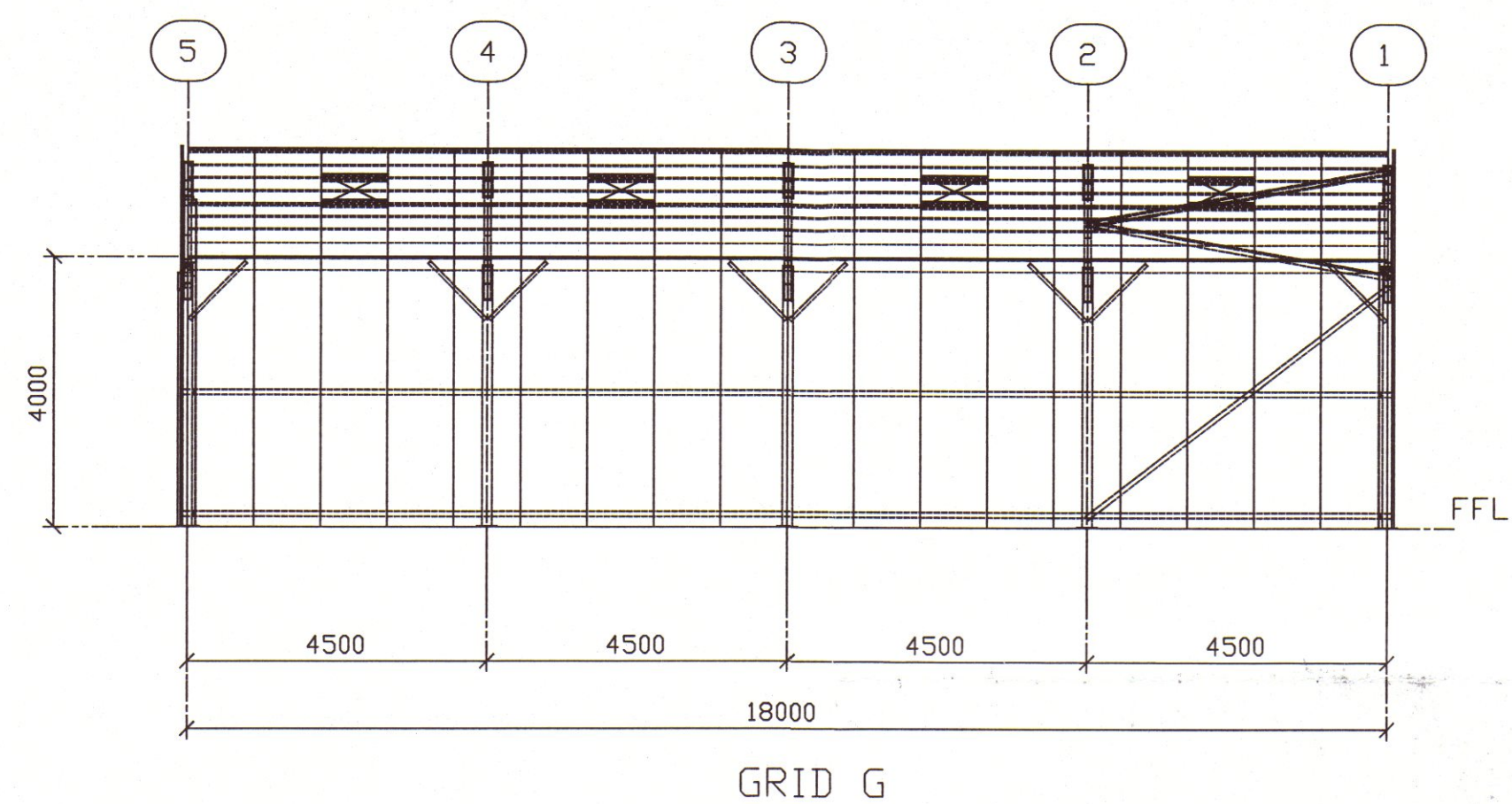

GRID G

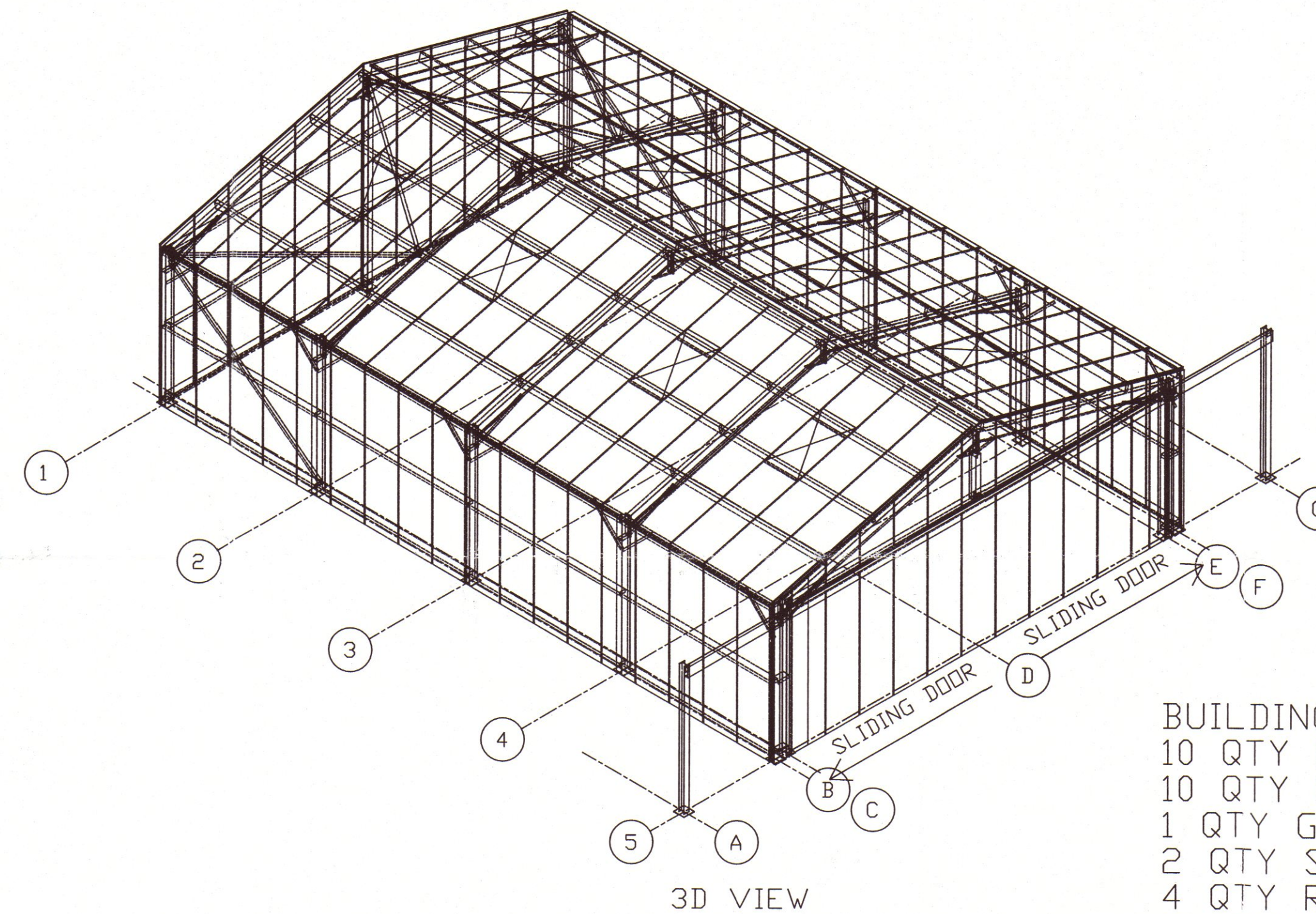

3D VIEW

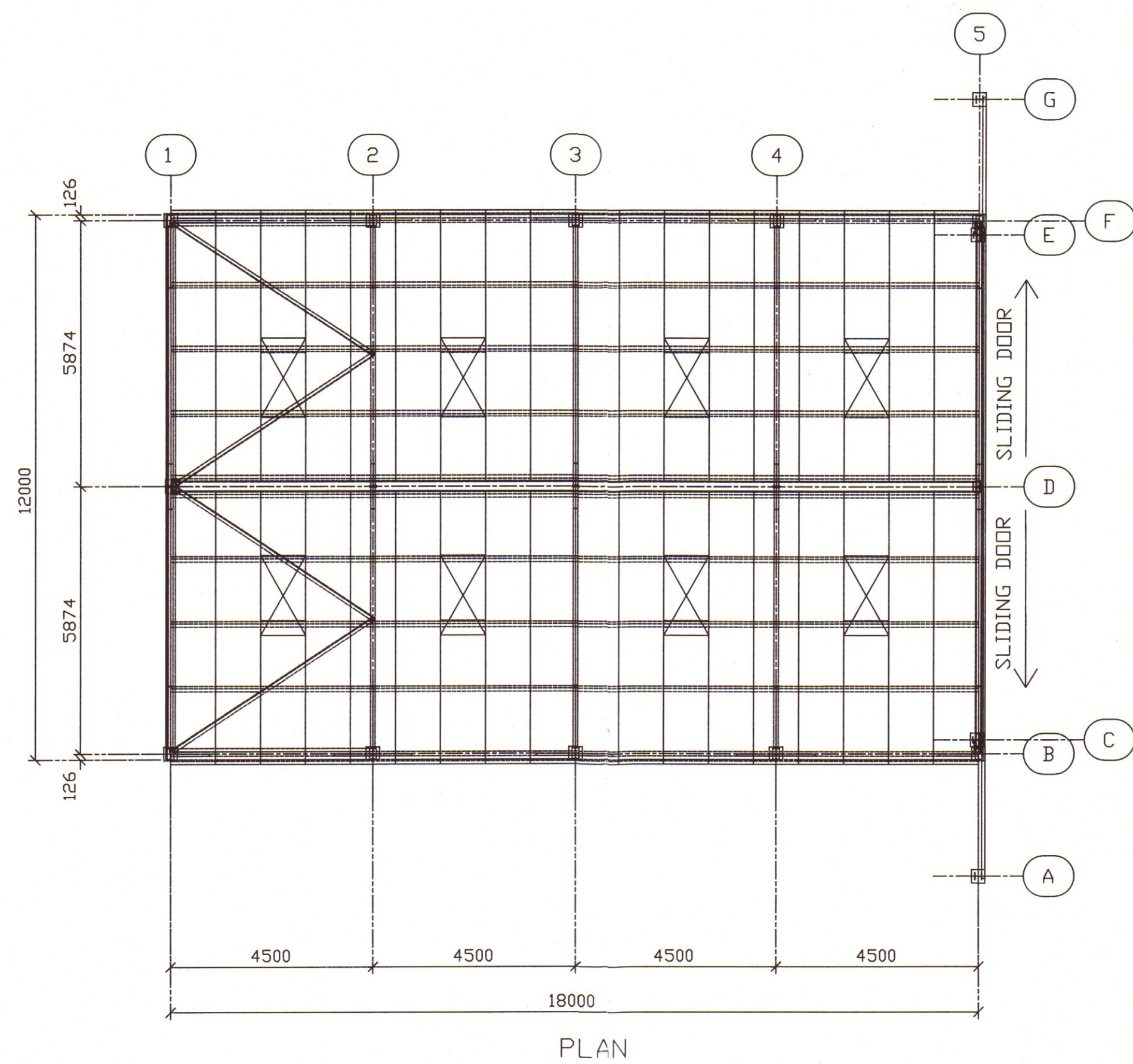

PLAN

- BUILDING 12m SPAN X 18m LONG
- 10 QTY MAIN STANCHIONS 254x146x31UB
- 10 QTY MAIN RAFTERS 254x102x25UB
- 1 QTY GABLE STANCHION 203x133x25UB
- 2 QTY SLIDING DOOR POSTS 203x133x25UB
- 4 QTY ROOF BRACE 70x70SHS
- 2 QTY VERTICAL BRACE 70x70SHS
- 1 QTY CHANNEL DOOR BEAM 260x75PFC
- 2 QTY OUT RIGGER DOOR POSTS 152x152x23UC
- 16 QTY KNEE BRACES 50x50x5RSA
- 1 QTY HANGER 203x133x25UB
- 1 QTY BRACE 70x70SHS
- ALL STEEL PAINTED GREY
- 2 LINES 75x200 TIMBER EAVES BEAMS
- 8 LINES 75x200 TIMBER PURLINS
- 2 LINES 75x175 TIMBER RAILS
- ALL TIMBER TREATED AND STAINED DARK BROWN
- ROOF CLADDING:
- 0.7th PLASTISOL COATED BOX ROOF PROFILE
- 8 QTY 1.5m ROOF LIGHTS BOX ROOF PROFILE
- SIDE CLADDING:
- 0.5th PLASTISOL COATED BOX PROFILE
- 2 QTY SLIDING DOORS 0.5th PLASTISOL BOX PROFILE
- ALL CLADDING JUNIPER GREEN
- 2 LINES 170mm HALF ROUND GUTTERS
- 2 110mm DOWN PIPES

CLIENT	BRENDAN WALSH		DRAWN	DD	08/12/20	KIT BUILDINGS DIRECT	Unit 16, Hilton Industrial Estate, Sutton Lane, Hilton, Derby, DE65 5F Tel:01283 735522 - Mob:07966 440 85 Fax:01283 735806 Email: concludtd@aol.com	
	PROJECT	GLENFORSA AIRFIELD, SALEN MULL, ARGYLL, PA72 6JN		CHECKED				
TITLE		GENERAL ARRANGEMENT DRAWING				1:100	769	GA001